

GUIDE

No: 20000922342

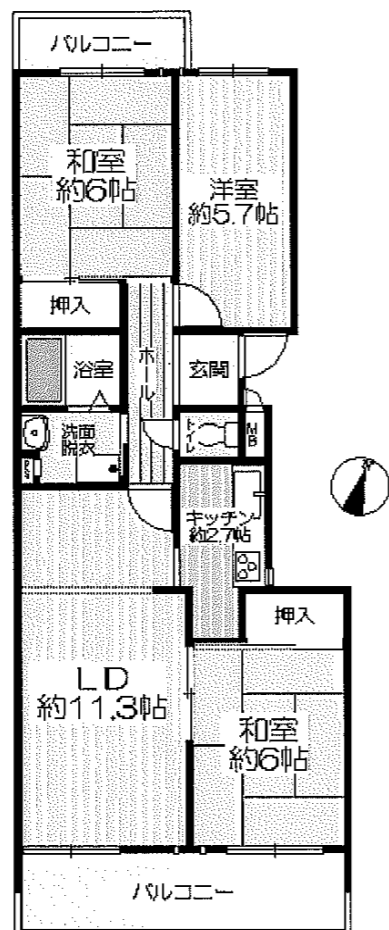

This picture is the thumbnail, If the picture is not in conformity with the actual conditions, the actual conditions shall prevail.

FUKUYAKA Real Estate Consulting (Shanghai) Co., Ltd.

Room68 38F NO.1601 West Nanjing Road, Jing'an District, Shanghai

TEL: 021-6136-3272

FAX: 021-6137-3210

Business Hours: 9:00AM to 17:00PM

MAIL: info@fukuyaka.cn

URL: http://www.fukuyaka.cn

FUKUYAKA

Principal	Operator	Form

OUTLINE

Building Name	MAISON Kasuga izuru			
Price	950 ten-thousand yen			
Cost	Management Fee	4,700 yen	Maintenance Reserve	6,650 yen
Location	Kasugadenaka 11-chome , konohana-ku, Osaka			
Traffic Routes	Nearest station	Hanshin Electric Railway nanba Line 【Sentoribashi】Station walk 12 minutes		
	Other station			
Land	Land Area	Register:1711.14m ²	Land Rights	1035/100000
	Ownership Nature	Ownership	Incidental Rights	/
	Territorial Law	/	Planning Land	Category 1 residential districts
property	Balcony Size	11.61m ²	Balcony Aspect	south
	Floor Area	68.51m ²	Floor Layout	3LDK
	Structure	RC structure5 floors above ground.This property is on F4		
	Year Built	Mar,1983	Number of units	44 units
	Construction Master		Construction Unit	Kumagai Gumi Co., Ltd.
	Management Company	Mitsui Real Estate Development residential service Kansai Co., Ltd.	Management Form	All commissioned & patrol
	Facilities /Equipment	Electricity	✓	Waterway
Sewage System		✓	Gas	City Gas
Parking		/	Parking Fee/M	/
Automatic door locks		✓	Elevator	✓
Other				
Comments	States	vacant	Delivery	conference
	<ul style="list-style-type: none"> • Pets can be kept(Be bound by Japanese rules and regulations) • To supermaker(superman)about 300m. • To Kasuga izuru shopping street about 150m. 			