

GUIDE

NO:3000000007

Leasing

Monthly Rent : 75,000 yen

Surface Yield : 6.42%

※ Western side corner room

Surrounding facilities

※ Distance 711 convenience about 80m

※ Distance Supermarket about 350m

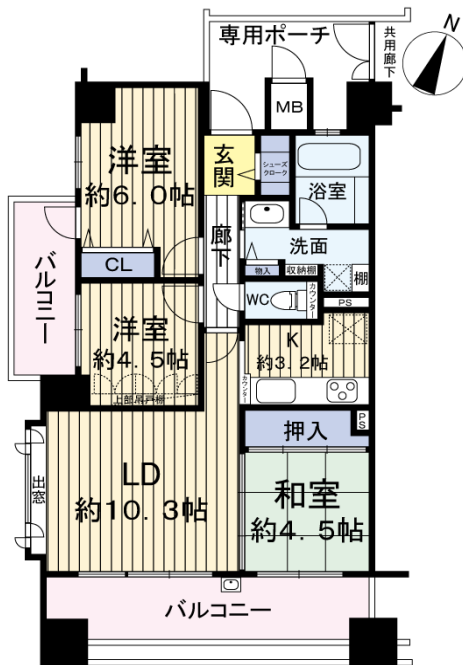

This picture is the thumbnail, If the picture is not in conformity with the actual conditions, the actual conditions shall prevail.

FUKUYAKA Real Estate Consulting (Shanghai) Co., Ltd.

ADD: Room68 38F NO.1601 West Nanjing Road, Jing'an District, Shanghai

TEL: 021-6136-3272

FAX: 021-6137-3210

Business Hours: 9:00AM to 17:00PM

MAIL: info@fukuyaka.cn

URL: http://www.fukuyaka.cn

FUKUYAKA

| Principal | Operator | Form |
|-----------|----------|------|
| | | |

OUTLINE

| | | | | |
|----------------------|---|--|---------------------|----------------------------------|
| Building Name | ESLEAD Fukushima No.5 | | | |
| Price | 1,400Ten-Thousand YEN | | | |
| Cost | Management Fee | 7,000Yen | Maintenance Reserve | 3,300Yen |
| Location | 8-17-16, Fukushima, Fukushima-ku, Osaka Shi (Room 401, Mansion Esrid Fukushima No.5) | | | |
| Traffic Routes | Nearest station | JR Circular Line【 Fukushima 】Station walk 6 minutes | | |
| | Other station | | | |
| Land | Land Area | Register:528.85m ² | Land Rights | 2726/277114 |
| | Ownership Nature | Ownership | Incidental Rights | / |
| | Territorial Law | / | Planning Land | Commercial area |
| property | Balcony Size | 3.53m ² | Balcony Aspect | W |
| | Floor Area | 27.26m ² | Floor Layout | 1K |
| | Structure | SRC structure, 15 floors above ground.This propety is on F4. | | |
| | Year Built | Feb.2007 | Number of units | 95 units |
| | Construction Master | Japan Eslead Co., Ltd. | Construction Unit | Ando Construction Co., Ltd. |
| | Management Company | Japan Eslead Co., Ltd. | Management Form | All commissioned & Daily service |
| | Facilities /Equipment | Electricity | ✓ | Waterway |
| Sewage System | | ✓ | Gas | City Gas |
| Parking | | ✓ | Parking Fee/M | 18,000~20,000YEN |
| Automatic door locks | | - | Elevator | ✓ |
| Other | | | | |
| Comments | States | Leasing | Delivery | Consultation |
| | <ul style="list-style-type: none"> • Monthly rent: 75,000Yen, Surface yield:6.42% • There are abundant eating and drinking establishments such as shopping streets in front of the station. | | | |



